

The Survive Alive House Family Activity Booklet



**INDIANA
MICHIGAN
POWER®**

A unit of American Electric Power

**“Saving lives
before the fire!”**

Dear Parent,

Each year thousands of people die in home fires in North America and tens of thousands are injured, some so badly they are disfigured for life. There are many ways we can act to reduce the awful toll of home fires, but every one of those ways start with an understanding of the hazards that create fires and the safe behaviors that can prevent fire or protect us if a fire does occur in our home.

We want your family to understand how to be fire safe, so we are committed to teaching fire safety. One of the most effective teaching methods is hands on learning and that is what your child has experienced at the Fort Wayne Fire Department's Survive Alive House, which is located in the Safety Village. The Survive Alive House, an extension of our in-school fire safety program, is a full size two story house equipped with numerous special effects that help us teach people the appropriate responses to an actual house fire in a totally safe but very realistic environment.

This activity book contains many fire safety activities for your family to do together. The safety booklet covers not only activities your child took part in at the Survive Alive House but also fire safety concepts we teach at your child's school. The center pages of this booklet contain a Home Fire Escape Plan and a Home Fire Safety Checklist that we have assigned to your child as a family homework project.

The home escape plan, along with practice fire drills twice a year, will help all members of your family learn the proper procedures in case of a real house fire. The home safety checklist will alert the family to any possible fire or burn hazards, and the correction of these hazards will do much to eliminate most accidental fires and burn injuries in your home. Please take the completion of these two activities seriously since you as a parent have a very positive impact on your child's behavior.

Fire safety education is the key to saving life and property from fire. Our goal is “**Saving Lives Before The Fire**” and working together as a team we can help accomplish this goal in our community! If you have any fire safety questions or would like to visit the Survive Alive House please call any of the Fort Wayne Fire Department Safety Education Division personnel at 427-1483, 427-1368, or 427-5179.

Fort Wayne Fire Department Survive Alive House
1270 South Phoenix Parkway
Fort Wayne, IN 46816



Indiana Michigan Power
P O Box 60
Fort Wayne, IN 46801
IndianaMichiganPower.com

A Message from Indiana Michigan Power

Indiana Michigan Power is proud to be a partner in education and is proud to partner with the Fort Wayne Fire Department to provide your child with this Fire Safety Education Booklet.

This booklet will help your child learn how to practice fire safety techniques, and we encourage you to read it carefully with your child. We hope you will enjoy the fun activities in the booklet and, at the same time, find good information on fire safety for your whole family.

Indiana Michigan Power believes safety education is important to the young people in our communities, and we applaud the Fort Wayne Fire Department's effort in providing them this fire-safety program.

Home Fire Escape Plan CROSSWORD PUZZLE

ACROSS

1. Does your family have a _____ Fire Escape Plan?
3. If your home catches on fire, you must have a plan to _____.
5. You must _____ Discuss, and Practice your Home Escape Plan now!
7. In a fire, it is important you _____ quickly.
8. On your floor plan, show your primary or normal _____ from a room with a solid black arrow.
9. You must have two ways out of every room, or _____ you could be trapped if your primary exit is blocked by smoke.
10. Planning ahead for emergencies is always worth the _____.
13. When a fire alarm sounds, feel your door to see if it is hot _____ cold.
14. Once outside, have everyone go to your meeting _____.
18. Smoke detectors _____ the best method of fire detection.
20. If the hallway is _____ of smoke or heat, take your primary exit.
23. Firefighters today can be either women or _____.
24. Don't let fire put an _____ to your family.
25. If your door is hot, or if the hallway is not _____ of smoke, take your secondary exit.
27. Make sure there are _____ matches within a child's reach.
28. Opposite of 27 across.
29. _____ prepared to notify fire department and offer any special help to infants, elderly, etc.
30. Make your fire drill a game for young children. In an emergency, they will follow directions instead of _____ under a bed or in a closet.
33. To practice your fire drill, have _____ start in their own bedroom.
34. Use _____ when exiting onto a rooftop.

DOWN

1. Every _____ should have a smoke detector for each level.
2. When drawing your floor plan, dimensions need not be _____.
3. Your floor plan should be an outline of the _____ floor area.
4. In order for your Home Fire Escape Plan to be _____, you must PLAN, DISCUSS, and PRACTICE it!
5. Decide upon a meeting _____ outside, away from the house to quickly check to see if everyone is safe.
6. If you have a babysitter or guest, be sure they know where your house _____ is located, in case they must give your address to the fire department.
11. 1,000-degree temperatures can travel far ahead of the actual _____.
12. If you think the door is safe to _____, brace your shoulder against the door, and open slowly.
14. A fire drill is when you _____ your Home Fire Escape Plan.
15. Be sure everyone is _____ to open windows and screens easily.
16. You should practice your Home Fire Escape Plan _____ six months.
17. Most fires start between the hours of _____ and 6:00 a.m.
19. Do, _____, Me, Fa, So, La, Ti, Do.
21. We test doors before opening because smoke or intense heat may be _____ the other side.
22. Many fires start in the _____, while cooking.
26. Most fires start while we are asleep in our _____.
29. A fire does not have to be _____ to give off deadly smoke.
31. Test your smoke detector each month _____ pushing the "test" button.
32. Outlined arrows on your floor plan show emergency exit _____ case fire blocks hallway or stairs.

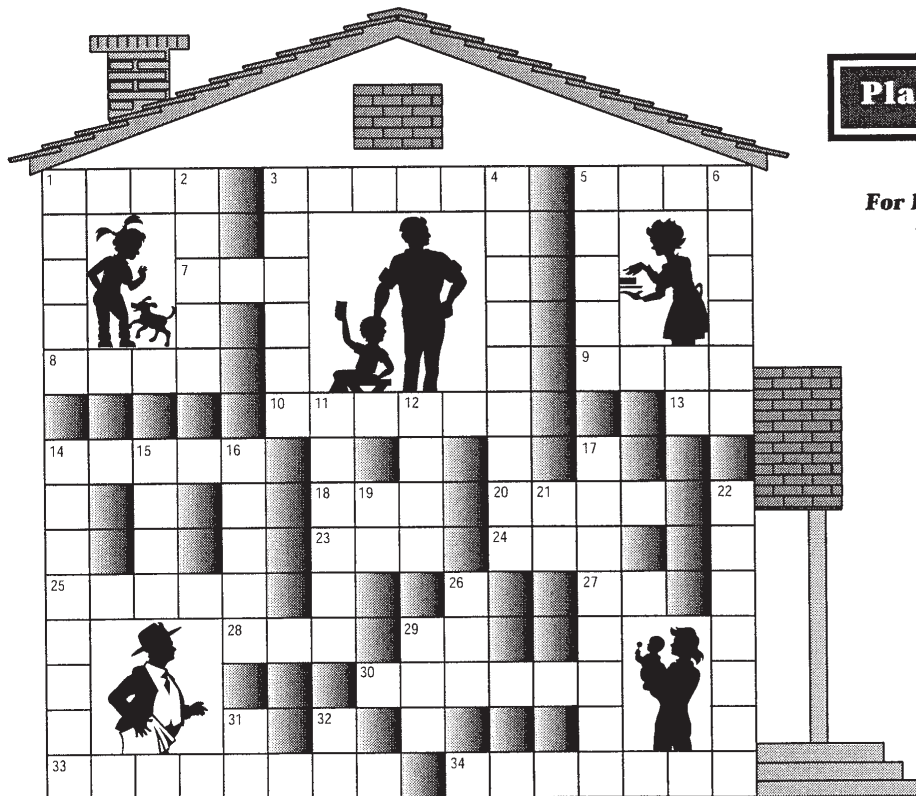

Plan • Discuss • Practice

**For help in completing this puzzle, read
"Your Home Fire Escape Plan."**

SOLUTION

Across: 1. home, 3. escape, 5. plan, 7. act, 8. exit, 9. else, 10. effort, 13. or, 14. place, 18. are, 20. void, 23. men, 24. end, 25. clear, 27. no, 28. yes, 29. be, 30. hiding, 33. everyone, 34. caution

Down: 1. house, 2. exact, 3. entire, 4. effective, 5. place, 6. number, 11. flames, 12. open, 14. practice, 15. able, 16. every, 17. midnight, 19. re, 21. on, 22. kitchen, 26. bed, 29. big, 31. by, 32. in

TELEPHONE TALK



XQNEVERZREPORTQAY
FIREXUNLESSYTHEREQ
ISYONE!YXZCALLINGQ
INXAYFALSEZALARMX
ISQDANGEROUSZAND
YAGAINSTQTHEZLAW!ZX



This boy is telling his friend something very important. To read what it is, cross out every Q, X, Y and Z.



Telephones are tools—NOT toys.

- ◆ We use telephones when we need to talk to someone right away.
- ◆ Telephones give us a way to call for help in an emergency.

HOW TO REPORT FIRES & EMERGENCIES

1 IDENTIFY YOURSELF

"My name is . . ."

2 TELL THE TYPE OF EMERGENCY

"My house is on fire."

3 GIVE THE ADDRESS

"My address is (house number and street) . . ."

4 GIVE THE PHONE NUMBER YOU ARE CALLING FROM

"My telephone number is . . ."

Be calm, speak clearly, and tell the operator all you know about the emergency.

Let the dispatcher or operator hang up first.

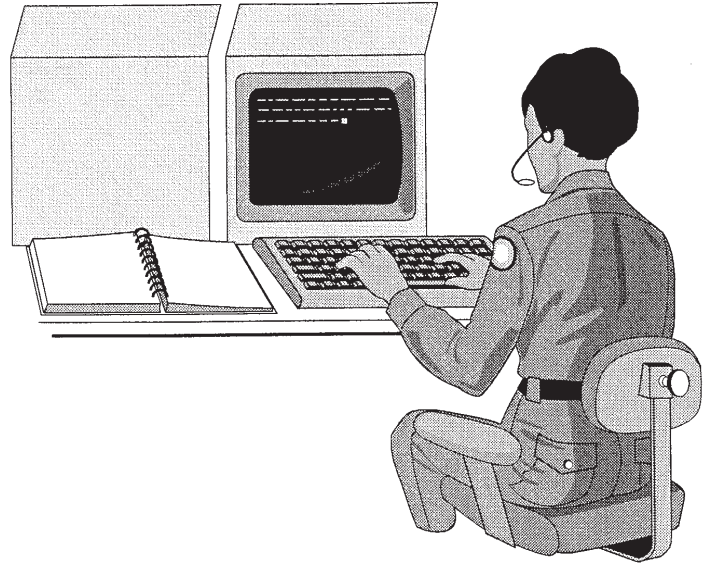

Everyone should know what to do in case of fire. First, you must know the phone number to call to report a fire or emergency. This number should be posted on each telephone at home.

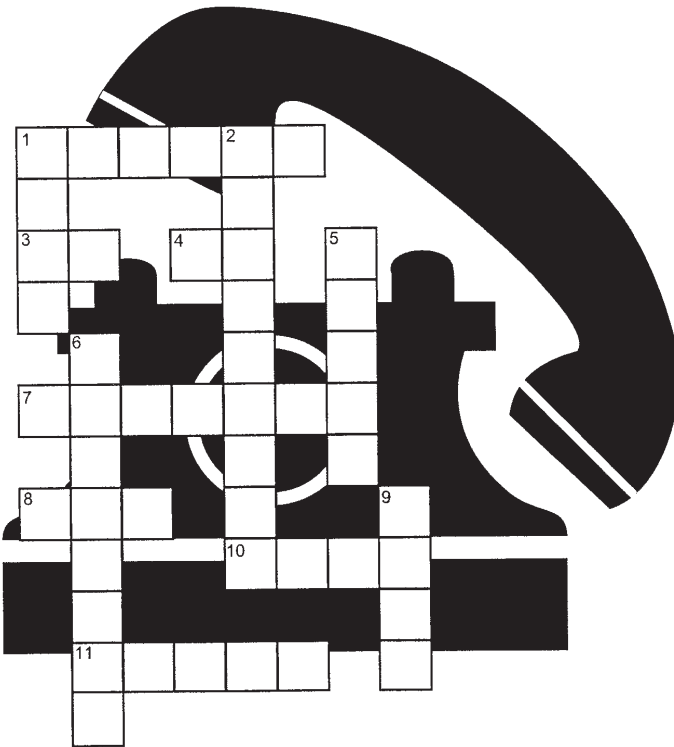

SOLUTION

Across: 1. number, 3. my, 4. be, 7. address, 8. and, 10. your, 11. first
Down: 1. name, 2. emergency, 5. house, 6. identify, 9. from

ACROSS

- To report a fire, you must know the emergency phone _____ for your area.
- The first thing you tell the emergency operator is, "_____ name is . . ."
- When reporting a fire, it is important to _____ calm.
- After you say your name and the type of emergency, tell the operator your _____.
- When giving your address, tell the house number _____ street name.
- The operator will also need to know _____ phone number.
- Let the dispatcher hang up _____.

DOWN

- Speak clearly and tell your _____ first.
- Tell the operator all you know about the _____.
- Your address is made up of your _____ number and street name.
- By giving your name, you _____ yourself.
- Give the phone number you are calling _____.

Smoke Detector Crossword Puzzle

ACROSS:

1. Make _____ Smoke Detector Test Day. (Follows Monday.)
6. Has your family _____ and practiced a home escape plan?
7. It's important that fire safety rules are under-_____. ("Under" is the first half of the word.)
8. Your fire escape plan can include a window _____ a door.
9. To be sure your smoke detector is working properly; don't let it get dusty. _____ it off.
11. Fire officials all _____ that homes should have a smoke detector.
13. Always _____ sure that you have two ways out of any room.
14. If you haven't had a fire drill lately, it's _____ that you did.
15. In a fire, get out fast. Don't take time to find your hat and _____.
16. The fire safety rules you learn now can help keep you safe for the _____ of your life.
17. You may need to use windows as an escape route. Be sure they will _____.
19. Be _____ to decide on a meeting place for your family to gather after you escape a fire.

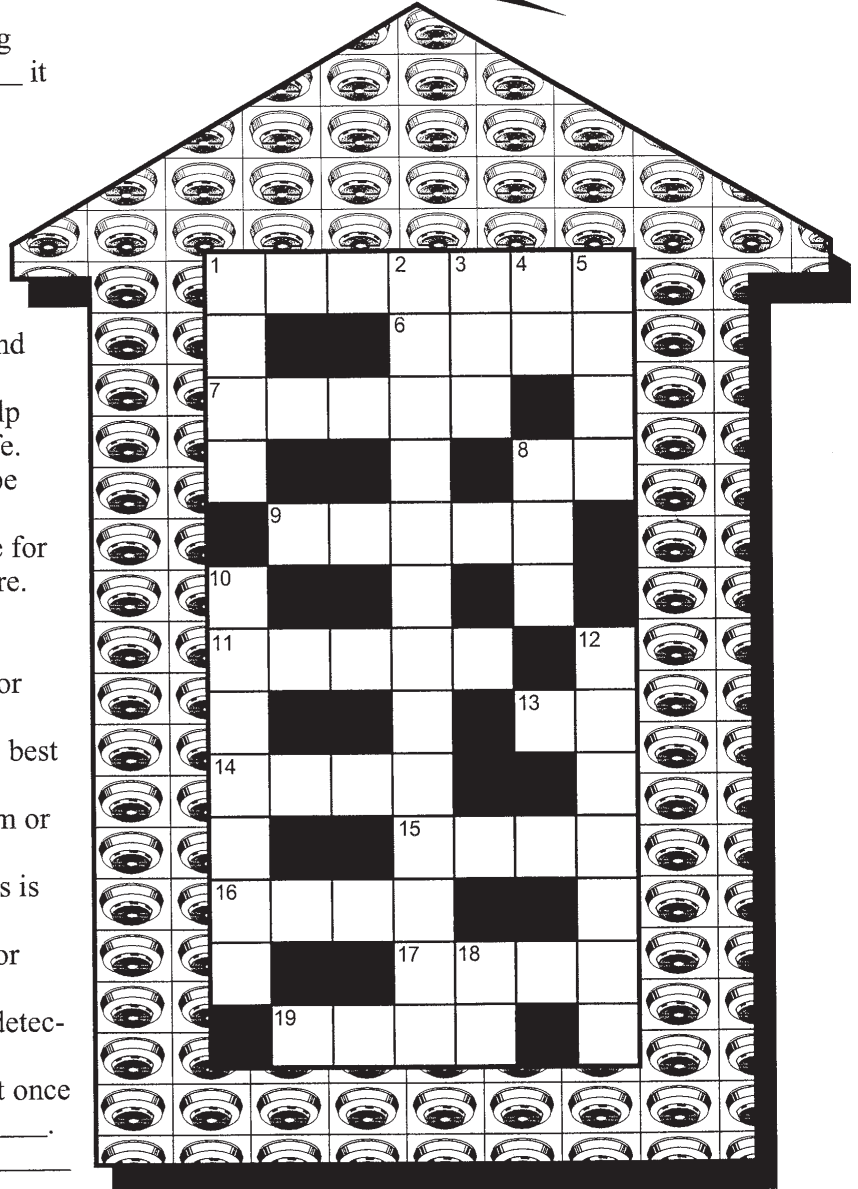
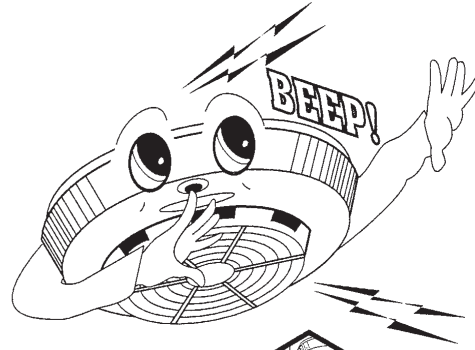

DOWN:

1. You should _____ your smoke detector regularly to be sure it works.
2. A _____ is the best way to alert you of a fire. (2 words)
3. Practice your home escape plan with Mom or _____.
4. A TV commercial selling smoke detectors is also called an _____.
5. Replace the battery in your smoke detector once each _____.
8. You should have at least _____ smoke detector on every level of your home.
10. If your smoke detector is "chirping" about once each minute, it needs a new _____.
12. Has your family decided on a _____ place to gather in case fire strikes?
18. Firefighters must stay physically fit. You stay fit by taking _____ classes. (Initials)

SOLUTION:

Across: 1. Tuesday, 6. made, 7. stood, 8. or, 9. clean, 11. agree, 13. be, 14. time, 15. coat, 16. rest, 17. open, 19. sure.
Down: 1. test, 2. smoke detector, 3. Dad, 4. ad, 5. year, 8. one, 10. battery, 12. meeting, 18. PE

Be a To Your Smoke Detector... ...and it will take good care of you!

A smoke detector at home is the very best way to give us early warning of fire. Many deaths and injuries in fires happen while people sleep. More fire deaths are caused by **SMOKE** than by flames.

We **MUST** be a friend to our smoke detector by taking good **CARE** of it.

Just as we need food to provide energy, the smoke detector needs a source of **ENERGY** also—a battery.

The battery in your smoke detector should be changed twice each **YEAR** in the spring and in the fall when you change your clocks.

A smoke detector tells you that it's "hungry" when it *chirps*. You should replace the weak battery immediately with a new one.

NEVER REMOVE the battery from a working smoke **DETECTOR**.

Even if you think your smoke detector has the power it needs, you should **TEST** it often to make sure. At least once every month ask an **ADULT** to test your detector.

You should have a detector on **EVERY** floor of your house. The downstairs unit will react sooner to a **FIRE** that might block escape routes through the first floor.

If you have more than one detector you might choose one that runs on batteries and one that runs on electricity. This way neither a battery failure **NOR** a power outage will leave

your family unprotected. With two detectors you have a better chance of at least **ONE** working when you need it, even if the other doesn't.

Use a vacuum cleaner to remove dust from air vents at **LEAST** once a year.

Never paint a smoke detector. If any paint gets inside, the unit may **NOT** work properly when you need it.

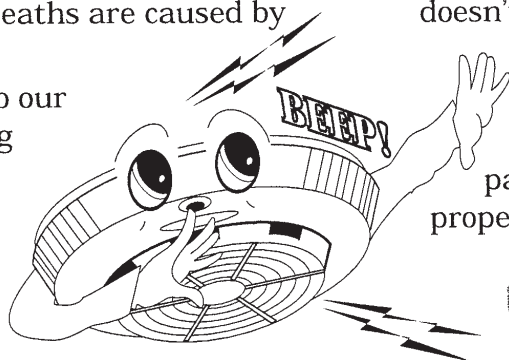

Keep your smoke detector happy and it will keep you and your family safe!

Find all of the words in bold capital letters (**LIKE THIS**) in the puzzle. Words can be found spelled from left to right, top to bottom, or on a diagonal. Letters can be used in more than one word.



F	I	R	E	N	E	R	G	Y	A
M	D	E	T	E	C	T	O	R	D
U	N	M	V	V	Z	A	E	Q	U
S	M	O	K	E	N	O	R	S	L
T	K	V	T	R	R	O	N	E	T
Q	L	E	A	S	T	Y	E	A	R

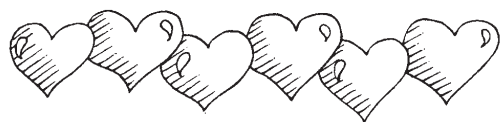

EVEN IN DINOSAUR DAYS

© 1999 Accent Publishing, Inc.

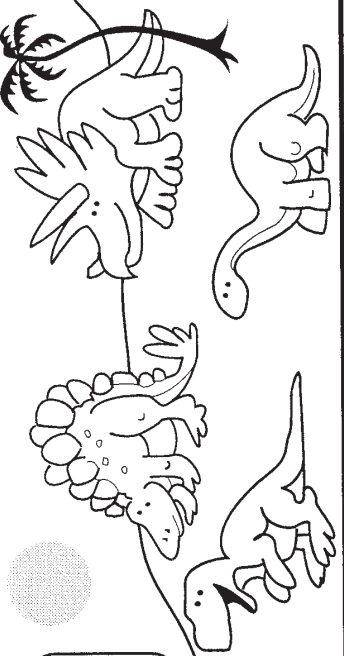

AND SO KIDS, NOW THAT THOSE CAVEMEN HAVE DISCOVERED FIRE, WE HAVE TO BE EXTRA CAREFUL AROUND HERE.

WHAT IS FIRE, ANYWAY?

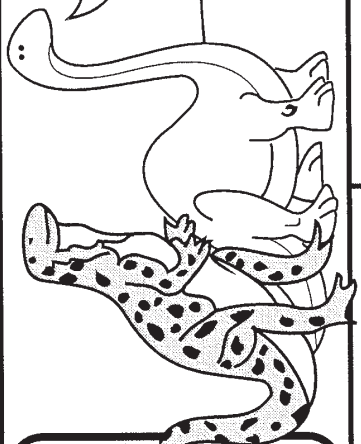

FIRE IS WHAT HAPPENS WHEN YOU GET FUEL, AIR AND HEAT TOGETHER. IT CAN BE GOOD, OR IT CAN BE BAD.

THE CAVEMEN ARE USING IT TO STAY WARM AND COOK THEIR DINO BURGERS SO THEY TASTE BETTER.

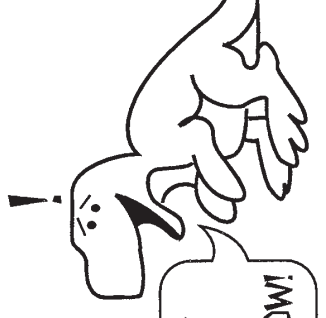

I'LL SAY WE HAVE TO BE CAREFUL NOW!



NOT ONLY THAT, BUT FIRE CAN BURN DOWN THE FOREST. THEN WE WOULDN'T HAVE A HOME, OR PLANTS TO EAT.



SQUAWK!

AND I WOULDN'T HAVE TREES TO LAND IN, AND I NEED BIG TREES!

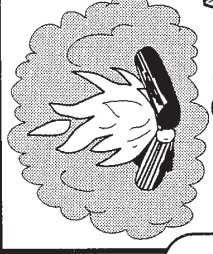

I SAW SOME CAVEMEN BUILD A FIRE, THEN GO AWAY AND LEAVE IT BURNING.

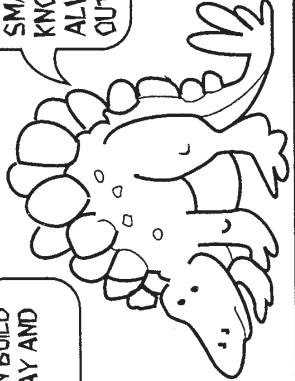

AND THEY SAY WE HAVE SMALL BRAINS! EVEN I KNOW THAT THEY SHOULD ALWAYS PUT THEIR FIRES OUT BEFORE THEY LEAVE.



KIDS, JUST STAY AWAY FROM THE CAVEMEN'S FIRES. YOU CAN GET BURNED. JUST LIKE THE TREES, AND NEVER PLAY WITH OR AROUND FIRE.



YEA! WE DON'T WANT TO BECOME EXTINCT OR SOMETHING!

WHAT SHOULD YOU DO IF...?

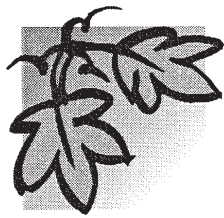

- A. Never open the door.
- B. Have a smoke detector on each level.
- C. Give it a new battery.
- D. Say no and walk away.
- E. Put a lid on it to smother the flames.
- F. Cool it in clean clear water.
- G. Give them to an adult.
- H. Call 9-1-1.
- I. Wear a seat belt.
- J. Crawl low in smoke.
- K. Have a fire drill.
- L. Stop, drop and roll.
- M. Wear a safety helmet.
- N. Go inside quickly.
- O. Drop under a door, table or desk; cover your head and hold on.

1. ...you find matches or lighters? _____
2. ...you have an emergency and need help? _____
3. ...your skin gets burned? _____
4. ...your clothes catch on fire? _____
5. ...you are caught in an earthquake? _____
6. ...you need to escape a smoky room? _____
7. ...you haven't practiced your fire escape plan? _____
8. ...you're riding in a car or truck? _____
9. ...you're riding a bicycle? _____
10. ...you're home alone and someone comes to the door? _____
11. ...your smoke detector "chirps"? _____
12. ...you have a fire in a pan on the stove? _____
13. ...you're outside when a thunderstorm starts? _____
14. ...you're walking and a stranger offers to give you a ride? _____
15. ...you have a two-level home? _____

Match the correct answer to each question. Write the letter for the best solution on the blank line next to the question.



ANSWERS

1. G, 2. H, 3. F, 4. L, 5. O, 6. J, 7. K, 8. I, 9. M, 10. A, 11. C, 12. E, 13. N, 14. D, 15. B.

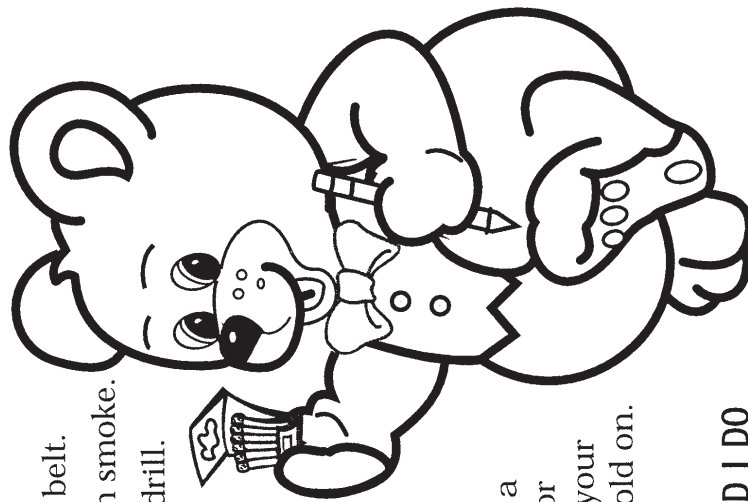

"WHAT SHOULD I DO WITH THESE MATCHES?"



Our Personal Home Fire Safety Checklist

Smoke Detectors

- As required by Indiana State law, a working smoke detector is placed outside each bedroom area and on every level of our home.
- For best protection, we have installed a smoke detector in every room of our house.
- We test all our smoke detectors at least once each month & replace batteries yearly.
- We never remove the battery from a smoke detector unless we are replacing it.
- All our smoke detectors are 4-6 inches from where the walls and ceilings meet.
- All our smoke detectors are cleaned regularly and we have never painted over them.
- We understand that hard-wired, interconnected smoke alarms are the best defense.
- We know that wireless smoke alarms are another option for good protection.
- If necessary for our family, we have installed hearing impaired smoke detectors.
- We have installed at least one of each type of detector, photoelectric and ionization, on every level of our house.

Fire Escape

- Our whole family has talked about and helped to draw a home fire escape plan.
- We all know two ways out of every room of our house, especially the bedrooms.
- If our smoke detector sounds, we know to "crawl low and go" because smoke and heat rise to the ceiling first and will spread rapidly throughout the house.
- We know to yell "fire" or use a whistle to awaken other family members.
- We know to feel interior doors before opening them, if warm we go to our second way out; if cool we open the door slowly.
- After opening a cool door, but before proceeding out the door, we know to look for smoke and fire and to feel for heat.
- We know to shut doors behind us as we escape from a fire.
- If our first way out is not safe we know to move quickly to our second way out.
- Our bedroom windows can be opened easily by all family members.
- We have easily accessible fire escape ladders in all upper story bedrooms.
- Everyone knows our special family meeting place where we will go immediately after escaping from a fire.
- We know to call 911 only after we escape from the house.
- We know not to take the time to try to get pets or valuables if a fire strikes our house.
"Get out and stay out! Never go back in for anything!"
- All of our doors, hallways, stairs, and bedroom windows are clear of obstructions.
- We have flashlights by our beds for emergencies.
- We have frequent family fire drills, even when some family members are sleeping.

Smoking/Matches/Lighters

- All matches and lighters in our house are kept in a securely locked drawer or cabinet.
- No smoking in bed or when sleepy is the rule for any smokers in our house.
- We have several large ashtrays around the house for smokers.
- Before emptying ashtrays we make sure the ashes are cold or pour water on them.
- When adults in our house use matches, lighters, candles, cigarettes, etc. they do so in a safe and appropriate manner.
- Everyone understands that matches and lighters are adult tools, not toys and just as power tools (and guns) are not to be left where children can have access to them.

Take Time For A Home Fire Escape Plan

If your family hasn't prepared and practiced a Home Fire Escape Plan recently, why not do it now?!

PLAN YOUR ESCAPE

Gather your family together to discuss fire escape.

- Do you have a smoke detector on each floor of your home? Test it to see if it works.
- Decide on a way everyone can alert the family of a fire. Remember, fire can block hallways, preventing you from reaching other bedrooms. (Of course, the best method of fire detection is your smoke detector!)
- Test doors before opening. Smoke and intense heat may be on the other side and can strike you down in seconds.
- Don't waste time getting dressed or gathering valuables — Get away and stay away!
- Decide upon a meeting place outside (away from the house) to quickly check to see if everyone is safe.
- Decide who will notify the fire department as soon as everyone is out. Plan to use a neighbor's phone. Speak slowly, "My name is... I'm reporting a fire at (address)..." Then wait to answer questions. Let the dispatcher hang up first.

PREPARE YOUR ESCAPE

- Draw a floor plan of your home. Label all rooms and show all doors, windows, and stairways.
- If on the upper floor, shade in any rooftops that can be used as a fire escape.
- Go to each bedroom and select the best window to be used for an emergency escape. Test the window to be sure it will open.

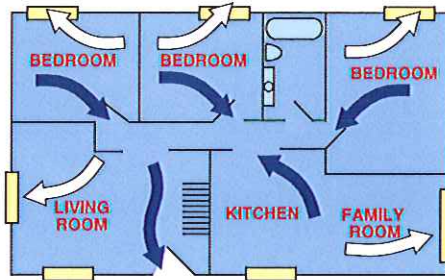

- On your floor plan, show all primary or normal exits with a solid black line.
- Show all secondary or emergency exits with an outlined arrow (the route you will take if your main exit is blocked by smoke or heat).

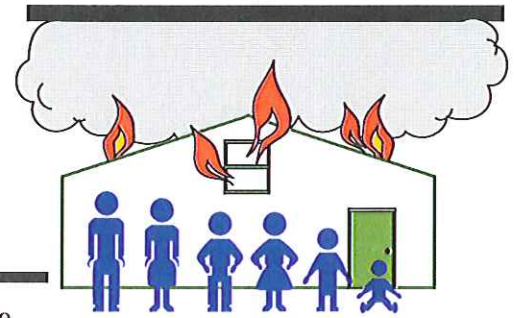

PRACTICE YOUR ESCAPE

- Have everyone in their own bedroom, with doors closed if you have a smoke detector.
- Sound the alarm.
- Everyone out of bed and low crawl to the floor. (Stay Low and Go.)
- Feel the door with your hand. Is it hot? Is smoke leaking in around the edges? If so, take your second way out.
- If you think it's safe to open the door, brace your shoulder against the door. Open the door slightly, being ready to slam it shut if any smoke rushes in.
- Have two drills, practicing both primary and secondary escape routes.
- Be sure everyone can open windows and screens easily, position ladder quickly, etc.
- Be prepared to offer any special help to infants, elderly, etc. on the way out. Never return to a burning building.
- Once outside, have everyone go to your planned meeting place and make sure everyone is accounted for.

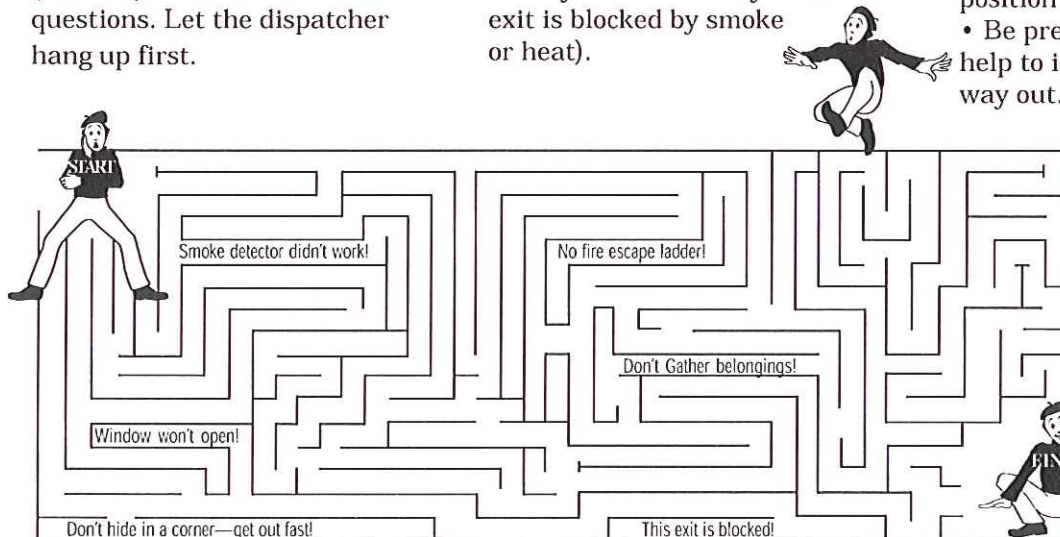

Make your escape from the maze. If you didn't plan, prepare, and practice your home escape plan, you'll run into trouble!

KITCHEN SAFETY

- ❑ Everyone understands that the kitchen is not a child's play area.
- ❑ No one ever leaves the kitchen when cooking on the stove or in the broiler.
- ❑ We never wear loose fitting clothing while cooking.
- ❑ When cooking, pan handles are turned to the back of the stove and we prevent utensil chords from dangling over counter edges.
- ❑ When cooking we always keep a pan lid nearby to cover the pan in case of fire.
- ❑ We keep oven mitts, dish and paper towels, and other flammable items away from the stove burners.
- ❑ We keep our kitchen cooking area clean and uncluttered.
- ❑ We understand that we never use water to try to extinguish a grease fire. (Only an ABC fire extinguisher, baking soda or a pan lid should be used.)

ELECTRICAL AND HEATING FIRE SAFETY

- ❑ We have our furnace cleaned and maintained regularly.
- ❑ Our furnace area is free of trash, papers, flammable products, etc.
- ❑ All space heaters (and grills) need space and are kept a minimum of three feet from items that could ignite or melt.
- ❑ We know never to refuel a kerosene heater inside the house.
- ❑ We never leave space heaters unattended or sleep while they are being used.
- ❑ Our chimney is cleaned and checked each year.
- ❑ Our fireplace has a metal screen or glass doors and they are kept closed whenever a fire is burning.
- ❑ If our house has gas appliances or a fireplace, we have installed a carbon monoxide detector near the bedrooms.
- ❑ None of our electrical chords are frayed, cracked or placed under rugs.
- ❑ None of our electrical outlets are overloaded.
- ❑ We use power strips with circuit breakers instead of extension chords.

GENERAL FIRE SAFETY

- ❑ We know to stop, drop and roll if our clothing catches on fire.
- ❑ We know our clothes will never catch on fire if we are careful when using fire.
- ❑ We never leave burning candles unattended and always keep them out of reach of children and pets.
- ❑ Our water heater thermostat is set between 120-130 F.
- ❑ We only keep gasoline and other flammable liquids in approved containers, which are stored outside the house.
- ❑ We never use a flammable liquid as a cleaning fluid or to start a fire in the fireplace.
- ❑ ABC fire extinguishers are kept on each floor and near exit doors.
- ❑ We know to cool burns with cold water, never use ice, lotions, creams or butter.
- ❑ We routinely check our clothes dryer and dryer hose for lint build-up.
- ❑ Our family understands that although children's curiosity about fire is normal, play and experimentation with fire is dangerous behavior that will be stopped immediately.
- ❑ Our family understands that most fires are caused by simple carelessness and it is every family member's personal responsibility to practice fire safety at all times.

For additional fire and life safety information, materials, or programs please contact the Fort Wayne Fire Dept. Safety Education Division at 427-1483, 427-5179, or 427-1368.

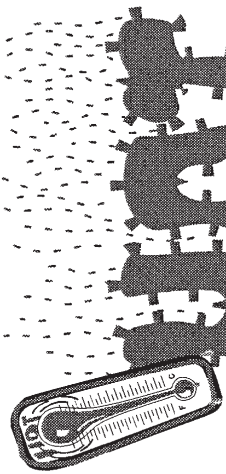

STUFF Don't Touch!



If you are burned, cool the burn quickly with clean, cool water. Soak the burned area for 15 to 20 minutes.

These are some of the things you might find around your house. They can be hot enough to burn you. If you get burned by touching something, it is called a "contact burn." Be careful to stay away from hot things that can burn you.

Write the number of the correct picture in the box next to its name.

- Toaster
- Candle
- Wood Stove
- Heater
- Lamp
- Birthday Candles
- Hot Bowl
- Light Bulb
- Lantern
- Teapot
- Stove
- Barbecue Grill
- Iron
- Match
- Skillet

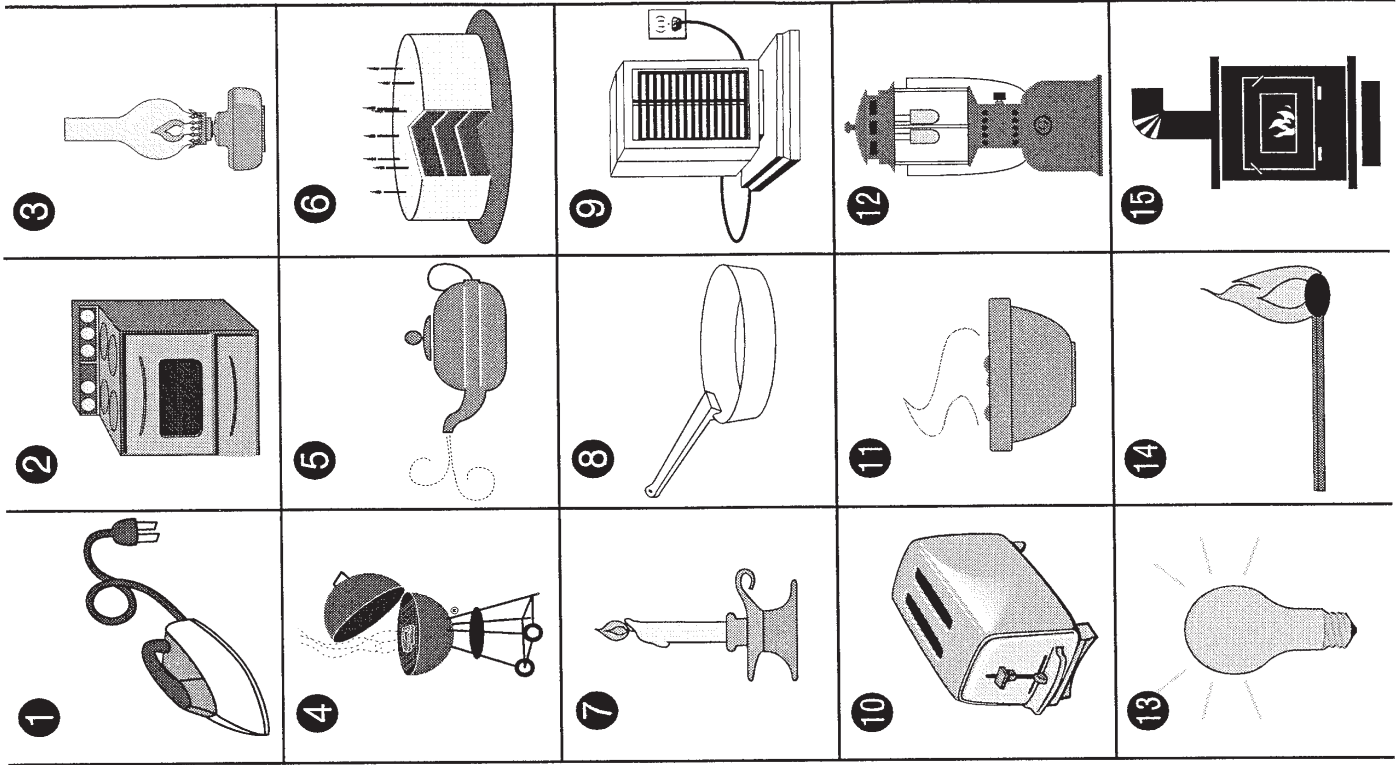

Word Twister

Below are words that are used in teaching fire safety.
Unscramble the letters to form each word:

P	C	E	A	S	E	<input type="checkbox"/>	<input type="checkbox"/>	<input type="checkbox"/>	<input type="checkbox"/>	<input type="checkbox"/>	<input type="checkbox"/>	<input type="checkbox"/>	<input type="checkbox"/>
O	H	E	M	<input type="checkbox"/>	<input type="checkbox"/>	<input type="checkbox"/>	<input type="checkbox"/>	<input type="checkbox"/>	<input type="checkbox"/>	<input type="checkbox"/>	<input type="checkbox"/>	<input type="checkbox"/>	<input type="checkbox"/>
K	S	E	O	M	<input type="checkbox"/>	<input type="checkbox"/>	<input type="checkbox"/>	<input type="checkbox"/>	<input type="checkbox"/>	<input type="checkbox"/>	<input type="checkbox"/>	<input type="checkbox"/>	<input type="checkbox"/>
R	E	I	F	<input type="checkbox"/>	<input type="checkbox"/>	<input type="checkbox"/>	<input type="checkbox"/>	<input type="checkbox"/>	<input type="checkbox"/>	<input type="checkbox"/>	<input type="checkbox"/>	<input type="checkbox"/>	<input type="checkbox"/>
L	R	D	L	I	<input type="checkbox"/>	<input type="checkbox"/>	<input type="checkbox"/>	<input type="checkbox"/>	<input type="checkbox"/>	<input type="checkbox"/>	<input type="checkbox"/>	<input type="checkbox"/>	<input type="checkbox"/>
V	E	S	A	<input type="checkbox"/>	<input type="checkbox"/>	<input type="checkbox"/>	<input type="checkbox"/>	<input type="checkbox"/>	<input type="checkbox"/>	<input type="checkbox"/>	<input type="checkbox"/>	<input type="checkbox"/>	<input type="checkbox"/>
T	U	O	R	E	<input type="checkbox"/>	<input type="checkbox"/>	<input type="checkbox"/>	<input type="checkbox"/>	<input type="checkbox"/>	<input type="checkbox"/>	<input type="checkbox"/>	<input type="checkbox"/>	<input type="checkbox"/>
W	A	R	C	L	<input type="checkbox"/>	<input type="checkbox"/>	<input type="checkbox"/>	<input type="checkbox"/>	<input type="checkbox"/>	<input type="checkbox"/>	<input type="checkbox"/>	<input type="checkbox"/>	<input type="checkbox"/>
P	T	O	S	<input type="checkbox"/>	<input type="checkbox"/>	<input type="checkbox"/>	<input type="checkbox"/>	<input type="checkbox"/>	<input type="checkbox"/>	<input type="checkbox"/>	<input type="checkbox"/>	<input type="checkbox"/>	<input type="checkbox"/>
R	P	O	D	<input type="checkbox"/>	<input type="checkbox"/>	<input type="checkbox"/>	<input type="checkbox"/>	<input type="checkbox"/>	<input type="checkbox"/>	<input type="checkbox"/>	<input type="checkbox"/>	<input type="checkbox"/>	<input type="checkbox"/>
L	O	R	L	<input type="checkbox"/>	<input type="checkbox"/>	<input type="checkbox"/>	<input type="checkbox"/>	<input type="checkbox"/>	<input type="checkbox"/>	<input type="checkbox"/>	<input type="checkbox"/>	<input type="checkbox"/>	<input type="checkbox"/>

Write the circled letters in the spaces below to complete the sentence.

Every home needs at least one _____.

Scrambled words are: escape, home, smoke, fire, drill, save, route, crawl, stop, drop, roll

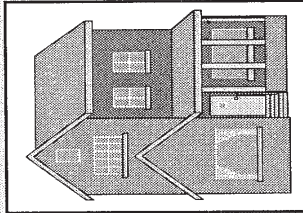

When **U** walk **2**
B sure **U** always cross
 the street at **A** marked
 crosswalk.

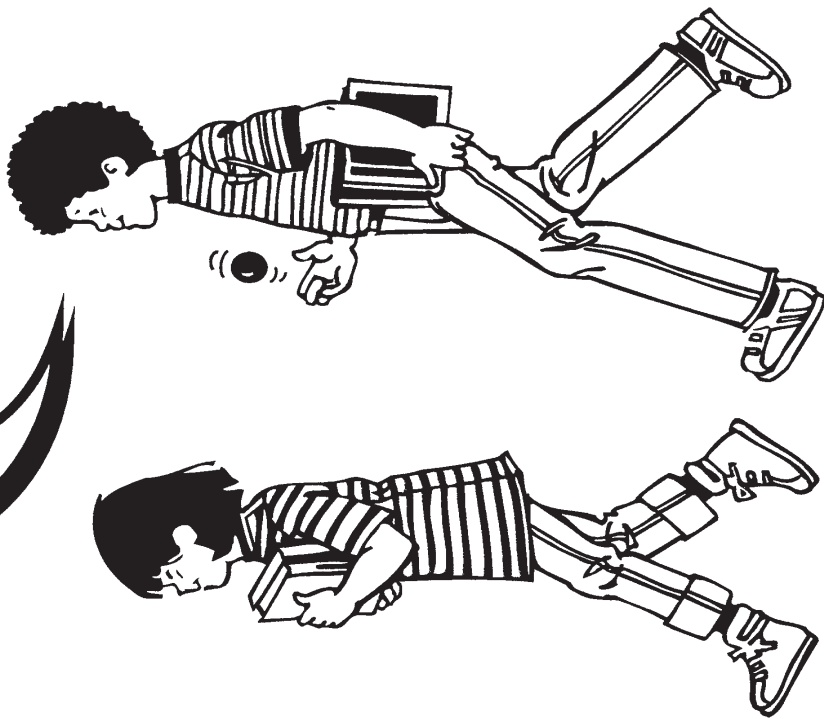



(And always walk facing traffic!)

THE SHOCKING TRUTH ABOUT LIGHTNING

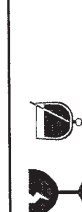
Lightning strikes at objects which extend upward from the earth, such as trees, towers, buildings, masts of ships, or even people! Use the code below to learn what to do during a summer lightning storm:











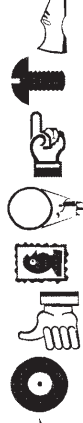











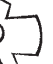























SECRET CODE

	= trees		= take		= or
	= metal		= swimming		= get
	= electrical		= don't		= at
	= stay		= once		= of
	= fields		= fences		
					= a
					= wire
					= appliances
					= open
					= the
					= use
					= if
					= water
					= from
					= bath
					= out
					= objects
					= inside
					= away
					= shower

Spring Break is the Time to Help With Spring Cleaning

Now that the long winter days are over, this is the best time of year to start getting your home in shape.

Helping with the spring cleaning around your house and yard can help protect your family from fire danger. Use this checklist to make a clean sweep of fire hazards around your home. If you find any dangers, ask a grown-up to help correct them.



A safe living area

- ✿ You should have a smoke detector on *each* level of your home.
- ✿ Be sure smoke detectors are in working order. Change the battery twice each year when you change your clock.





You might find the things in the list below around your home or yard. These are places where fire can start. Find these words in the puzzle from left to right or from top to bottom.

GREASE	NEWSPAPERS	MATCHES
CORDS	RUBBISH	FIREPLACE
LAMP	LEAVES	CHIMNEY
GASOLINE	OVEN	HEATER
PAINT	BRANCHES	STOVE

M Q T N G H V R G Y L D Z

A U F I R E P L A C E C R

T P L O E A D A S O A H U

C A R V A T Z M O R V I B

H I W E S E A P L D E M B

E N K N E R J V I S S N I

S T O V E B R A N C H E S

Y N E W S P A P E R S Y H

Summer Safety Fill-In Puzzle

- Clear the area around your **CAMPFIRE** by 6 to 10 feet.
- Never leave a **FIRE** unattended.
- Never dive into water **THAT** might be too shallow or contain hidden rocks.
- When **SWIMMING** in rivers or lakes, stay completely away from boats. They may not see you in the water.
- It **IS** safest to swim in a marked swim zone.
- Play **FAR** away from a heated barbecue **GRILL**.
- Be sure the barbecue grill is located in a **SAFE** place. Keep things that will burn a safe distance away in all directions.
- Never use a gas or **CHARCOAL** grill inside a house or tent.
- You should always have with you a bucket of water, an axe, and a shovel **WHEN** you're camping in the woods.
- Be extremely **CAREFUL** with cooking or heating appliances and with lamps or lanterns.
- When **TRAVELING**, be sure to stay only in hotels or motels that have smoke detectors.
- Have your family **DRAW** up an escape plan from your hotel room.
- If there is a fire, don't panic! Feel your door before opening it. Then stay low and go, but don't be **SLOW**.

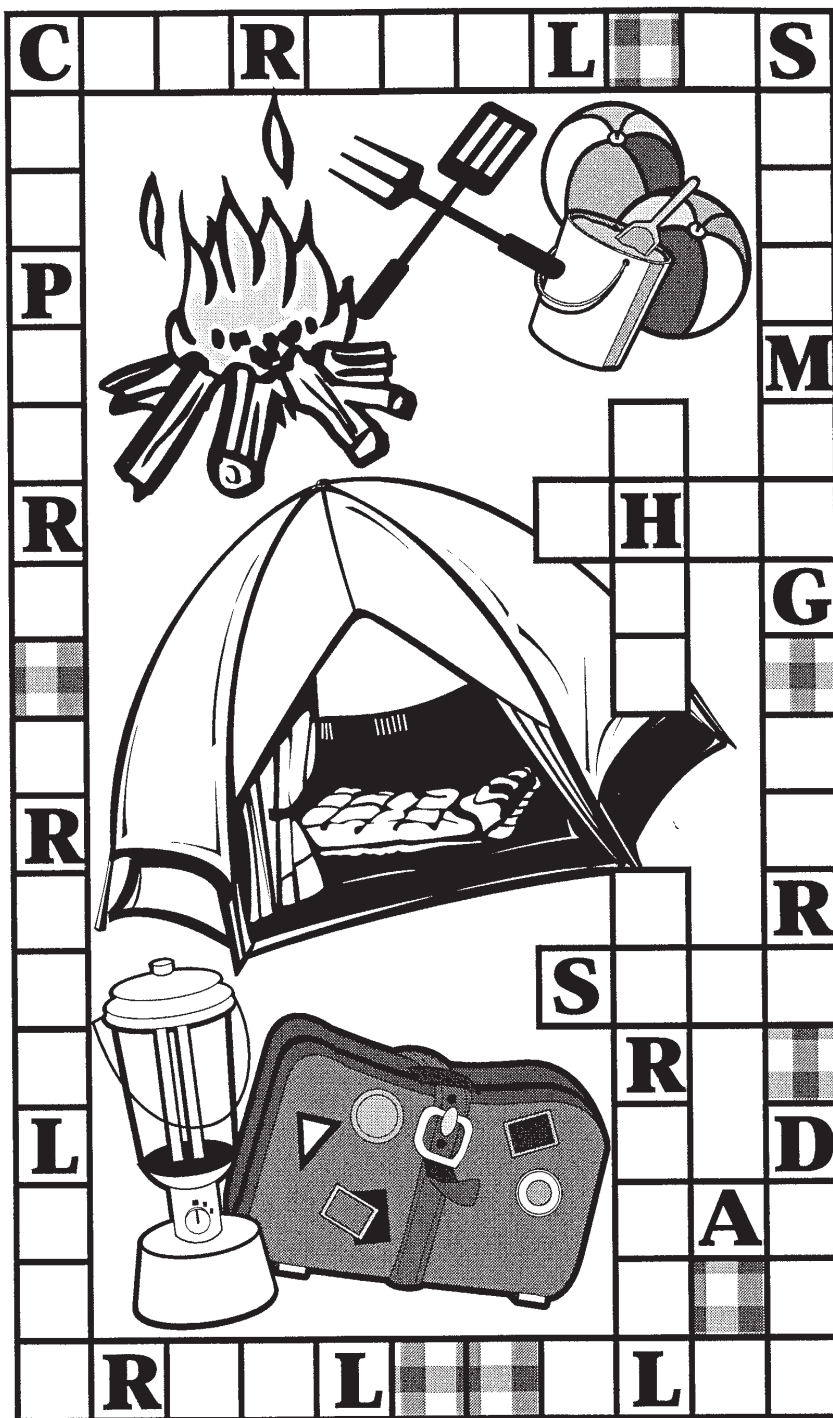

In the text are words in large bold capital letters (**LIKE THIS**). Find the correct place for each word in the puzzle. Fill in the missing letters.

Don't Be Slow to Remember Fire Safety This Fall

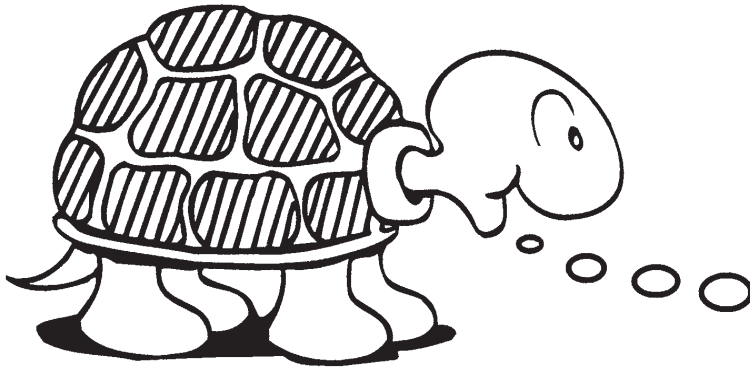

Find the words in the puzzle. The leftover letters (from left to right, going top to bottom) will spell out a message about escaping a smoky room. This is something I *always* remember to do!



FIRE
SAFETY
TEST
SMOKE
DETECTOR
MATCHES
ARE
TOOLS
CLEAN
CHIMNEYS
COOK
WITH
CARE



C	S	D	W	I	T	H	S	C
L	T	E	S	T	T	A	A	H
E	Y	T	O	O	L	S	F	I
A	L	E	S	M	O	K	E	M
N	O	C	A	R	E	W	T	N
M	A	T	C	H	E	S	Y	E
C	O	O	K	A	R	E	A	Y
F	I	R	E	N	D	G	O	S

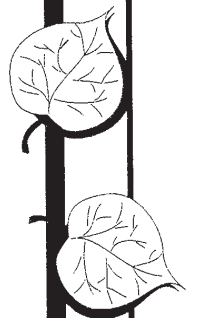

_____ !

WINTER SAFETY CROSSWORD

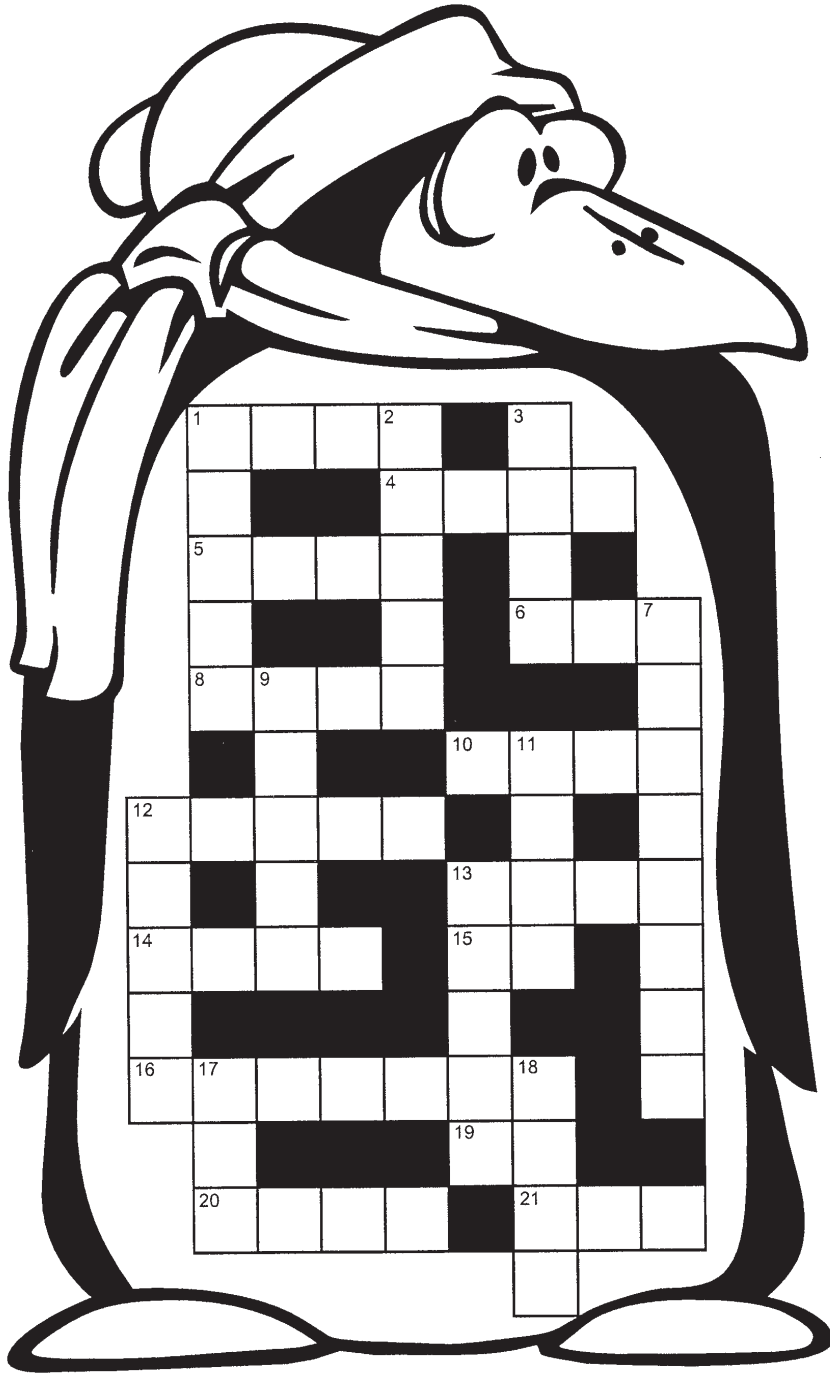

8. Keep anything that will burn 3 feet away from a wood stove. Check for “combustibles” on both sides, front and in the ____ of the stove.
10. Empty fireplace ashes into a metal container. Place them outside and away from your _____.
12. If there is a fire hydrant near your home, keep it _____ of snow so the fire department can find it if it is needed.
13. Be sure to wear your _____ belt when riding in a car or truck.
14. Remember that matches and lighters are tools for adults, not _____ for children.
15. Use a screen ____ front of your fireplace to prevent sparks from jumping out.
16. Never burn charcoal indoors for either _____ or cooking. Burning charcoal can give off poison gases.
19. When walking on dark winter days, be sure to wear light-colored clothing ____ you can be seen by drivers.
20. Be sure to turn electric blankets off when you are _____ using them, so they don’t overheat.
21. Never _____ the berries from holiday plants. They may be poison.

DOWN

1. An open flame should never be used to try to thaw frozen _____ pipes. A fire could start inside the wall.
2. Use hot water or a hand-held hair _____ to thaw frozen water pipes.
3. It’s a good _____ to have an emergency kit handy in case the electric power goes out during a storm.
7. Use only heavy-duty extension cords on _____ heaters.
9. Be sure _____ level of your home has a working smoke detector.
11. Check to see that all bedroom windows in your home will _____ easily. You might need to use them to escape a fire.
12. Always dress warmly so you don’t _____ a cold.
13. Look for exit _____ when shopping in stores so you know how to escape in case of fire.
17. After the _____ of winter comes spring.
18. Before your family _____ to sleep be sure your fireplace fire is out.

ACROSS

1. Heating with _____ causes many home fires every year.
4. Never _____ your bike on icy streets.
5. Don’t use electric space heaters in bathrooms, or other areas where _____ may come in contact with water.
6. Stay away from space heaters—especially if you _____ wearing a nightgown or other loose clothing.

SOLUTION

Across: 1. wood, 4. ride, 5. they, 6. are, 8. rear, 10. home, 12. clear, 13. seat, 14. toys, 15. in, 16. heating, 19. so, 20. done, 21. eat
 Down: 1. water, 2. dryer, 3. idea, 7. electric, 9. every, 11. open, 12. catch, 13. signs, 17. end, 18. goes

Keeping Warm Wisely With Wood

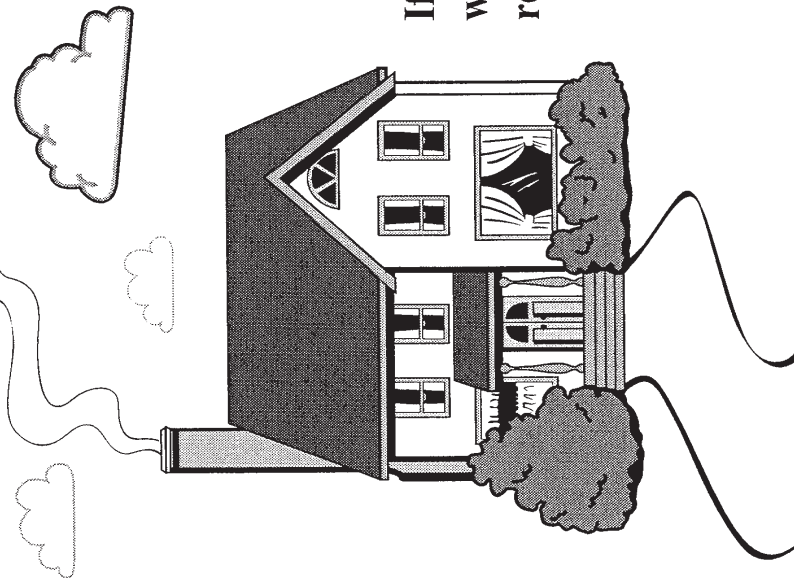

If your family heats your home with a wood stove or fireplace, remember these fire safety rules.

- Be sure your family has a permit for the installation of any wood stove.
- Make sure the stove is far enough away from walls.
- Protect your floor from heat and sparks.
- Burn short, hot fires.
- Don't leave the stove burning while you are away.
- Never use flammable liquids to start a fire.
- Don't burn trash or wet wood in your stove.
- Never leave anything flammable within three feet of your stove. This includes firewood and furniture.
- Use a covered metal container to empty ashes.
- Pipes and chimneys should be cleaned every year.
- Stoves can get very hot. Stay away!
- Call your local fire department for more information about wood stove safety.

**FINISH THE PICTURE BY CONNECTING EACH DOT.
JUST FOLLOW THE NUMBERS . . .
AND YOU'LL SEE WHAT GETS HOT!**

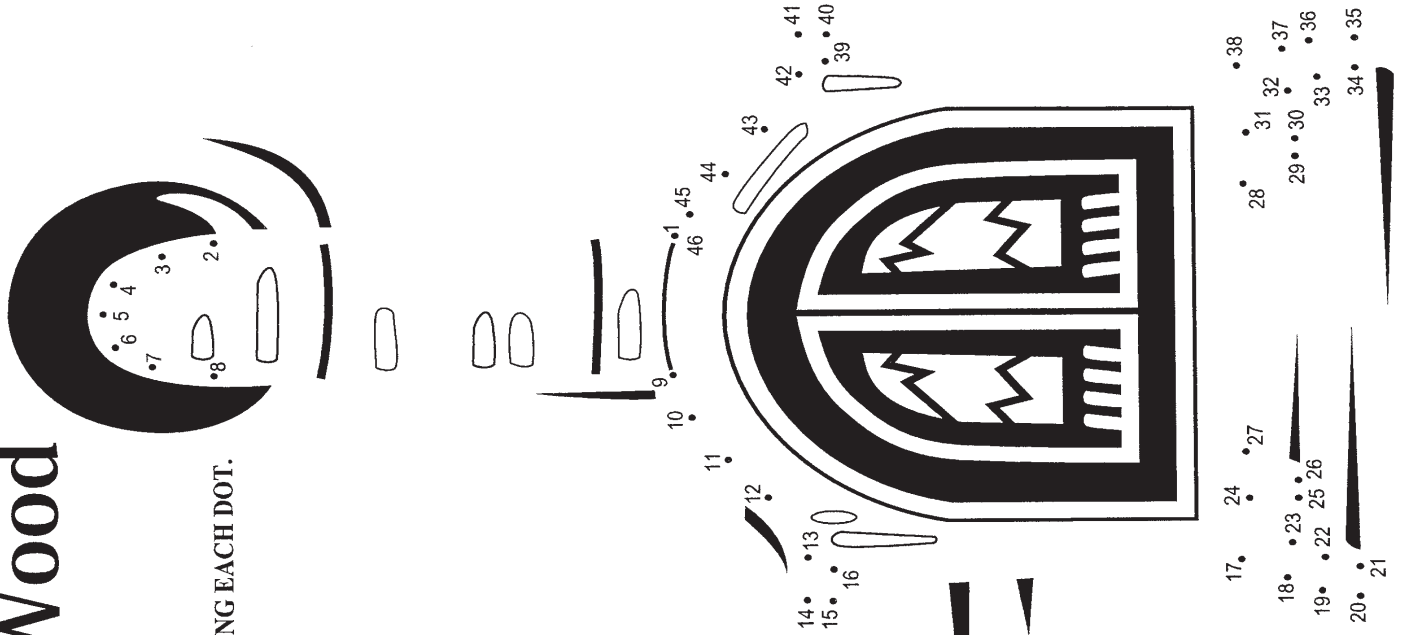



Use the word list below to read the story and complete the crossword puzzle.



Once upon a time there was a wonderful princess named Indra. She was fast asleep in her (3 across) in the castle. Suddenly, the princess was awakened by the (17 across) sound of the (2 down) (4 down) in the hall outside her bedroom. Indra and her parents, the King and Queen, had very (16 across) practiced their (1 down) so she knew just what to do.

She got out of (9 across) quickly and crawled to the door. When she put her (1 across) on the (13 across), it felt hot. The princess knew that she shouldn't open it because there might be (10 down) on the other side. Her teachers at the royal school had taught her that homes (14 down) always have (18 across) of every room. So Princess Indra crawled to her other exit, the window.

After she got outside on the castle grounds, she went directly to their family (5 down) place. They had planned ahead to meet at the (8 across) of the bridge over the castle moat, in case there was ever a fire in the castle. Soon, everyone (7 across) who lived in the castle was there, the servants and the king and queen. They (15 down) that all were safe and no one was hurt. Even the royal dog came running up to greet Princess Indra at the meeting place.

Luckily, this castle had another kingdom right next door. The King went to the (12 across) door neighbor's castle to phone the fire (6 down), while everyone else waited, (2 across), for the firefighters to arrive. In (16 down) a few minutes, the friendly firefighters came and put out the fire....



...AND THEY (11 across) LIVED HAPPILY EVER AFTER.

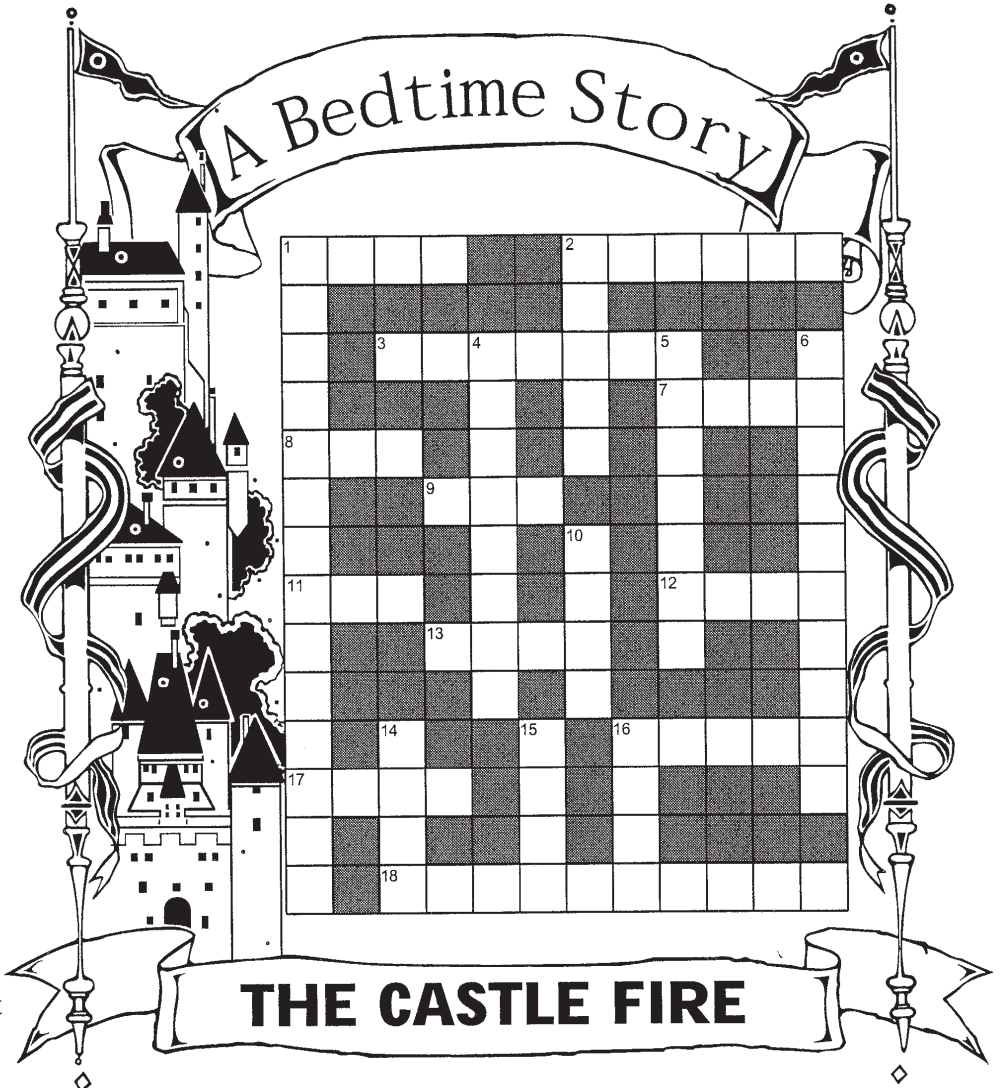

department

all

smoke

detector

often

hand

door

else

fire

two ways out

bedroom

meeting

end

knew

next

loud

home escape

plan

safely

only

must

bed

Safety Village



Fort Wayne Fire Department
Survive Alive House
1270 South Phoenix Parkway
Fort Wayne, IN 46816